

LINEA CONTINUOUS PLANK

LINEA Continuous Plank is a low cost, progressively installed, open-reveal linear wood slat system designed for interior and exterior wall and ceiling installations where a seamless, random joint, linear appearance is preferred. LINEA Continuous Plank is offered as random lengths for solid wood designs and 8' lengths for wood veneer composite designs. LINEA Continuous Plank utilizes concealed clip hardware to maintain consistent reveal gaps and to ensure even surface alignment between slats from end-to-end and is generally faster to install than the wood-backed versions. LINEA Continuous Plank is available in multiple standard module sizes, can be customized or mixed and matched together for a totally unique look. LINEA Continuous Plank is available in a wide variety of solid wood or real wood veneer options and in standard, custom, or simulated finishes. When combined with acoustical insulation, LINEA Continuous Plank can achieve medium to high acoustic performance.

SPECIFICATION—*example*

- Type:** LINEA Continuous Plank
- Species:** Select from Solid Wood or Custom Veneer Options
- Core:** Solid Wood or Fire Rated MDF
- Edge:** Square, grooved or with matching edge banding (veneer only)
- Module Size:** Select from chart
- Finishes:** Natural Clear, Custom Stained or Tinted Clear Finishes in *Matte, Satin or Semi-Gloss Sheen*
- Reveal:** Open, Standard Black Fabric or Black ABS Plastic (Exterior)
- Fire Rating:** Class A per ASTM E-84 (USA) and CAN/ULC S102 (Canada)



Linea Continuous Plank

FEATURES | BENEFITS

- Progressively installed to T-Bar with Reveal and Alignment Clips.
- Ideal for Interior or covered Exterior ceilings or walls (at 90° angle).
- Black Fabric (*interior*) or Black Plastic (*exterior*) available to cover the reveal.
- Several module sizes to choose from
- Available in a wide variety of solid wood and wood veneers.
- Class A Fire Rated per ASTM E-84 and CAN/ULC S102 is standard.
- FSC Certified and other responsibly harvested wood options available.
- Designed for seismic and non-seismic areas.
- Ships in random lengths (Solid Wood) and 8' Lengths (Veneer).
- Available with LINEA Textured Face
- Available with LINEA Microperforations



LINEA CONTINUOUS PLANK

PRODUCT DATA SHEET

LINEA Plank		Blade Profiles & Reveal Options					
		USA (in)			Metric (mm)		
Module Size	Substrate	Thickness	Width	Reveal	Thickness	Width	Reveal
3"	Veneer & Hardwood	3/4	2-1/4	3/4	19	57	19
3"	Soft Wood	11/16	2-1/4	3/4	16	57	17
4"	Veneer & Hardwood	3/4	3-1/4	3/4	19	82	19
4"	Soft Wood	11/16	3-1/4	3/4	16	82	17
4-1/2"	Veneer & Hardwood only	3/4	3-3/4	3/4	19	95	19
6"	Veneer & Hardwood	3/4	5-1/4	3/4	19	133	19
6"	Softwood	11/16	5-1/4	3/4	16	133	17

Solid Softwoods are milled to 5/8" or 11/16" thickness. Solid Hardwoods are milled to 3/4" thickness

Slat thickness and depth may vary between softwoods, hardwoods and veneer

Additional sizing and pattern options are available. **Contact a LINEA representative for more details**

CONTINUOUS PLANK MODULES—SECTION DETAILS

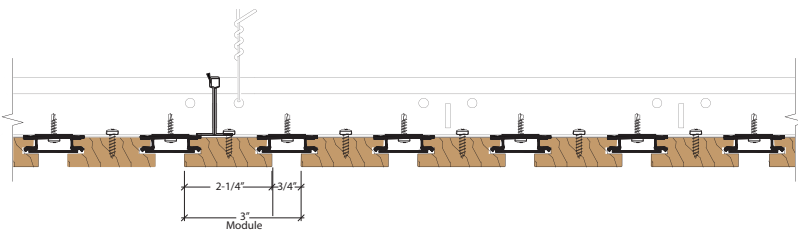

3" MODULE

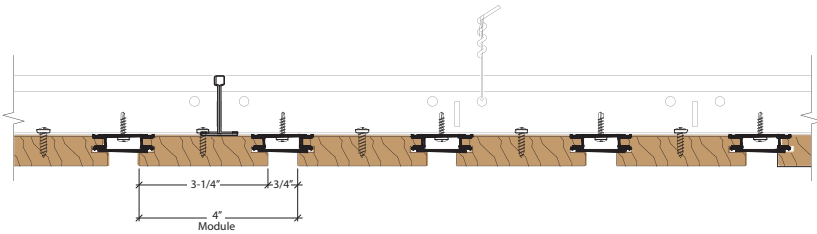

4" MODULE

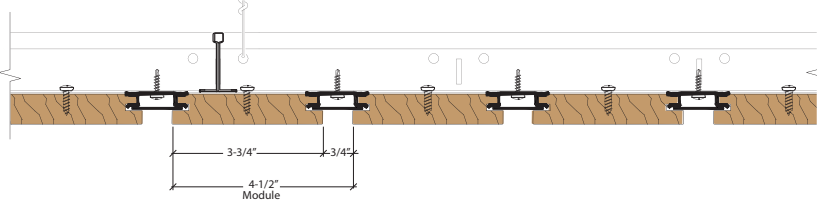

4-1/2" MODULE

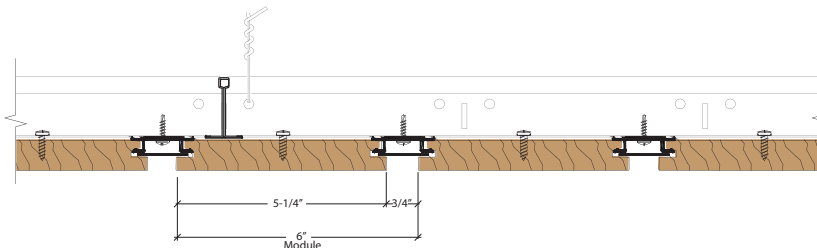

6" MODULE

*Product information is subject to change without notice.

Revision Date: November 2023

T 604-776-2265 sales@lineaceilings.com lineaceilings.com 2320 Peardonville Road Abbotsford, BC Canada V2T 6J8

LINEA CONTINUOUS PLANK

PRODUCT DATA SHEET

Install Detail

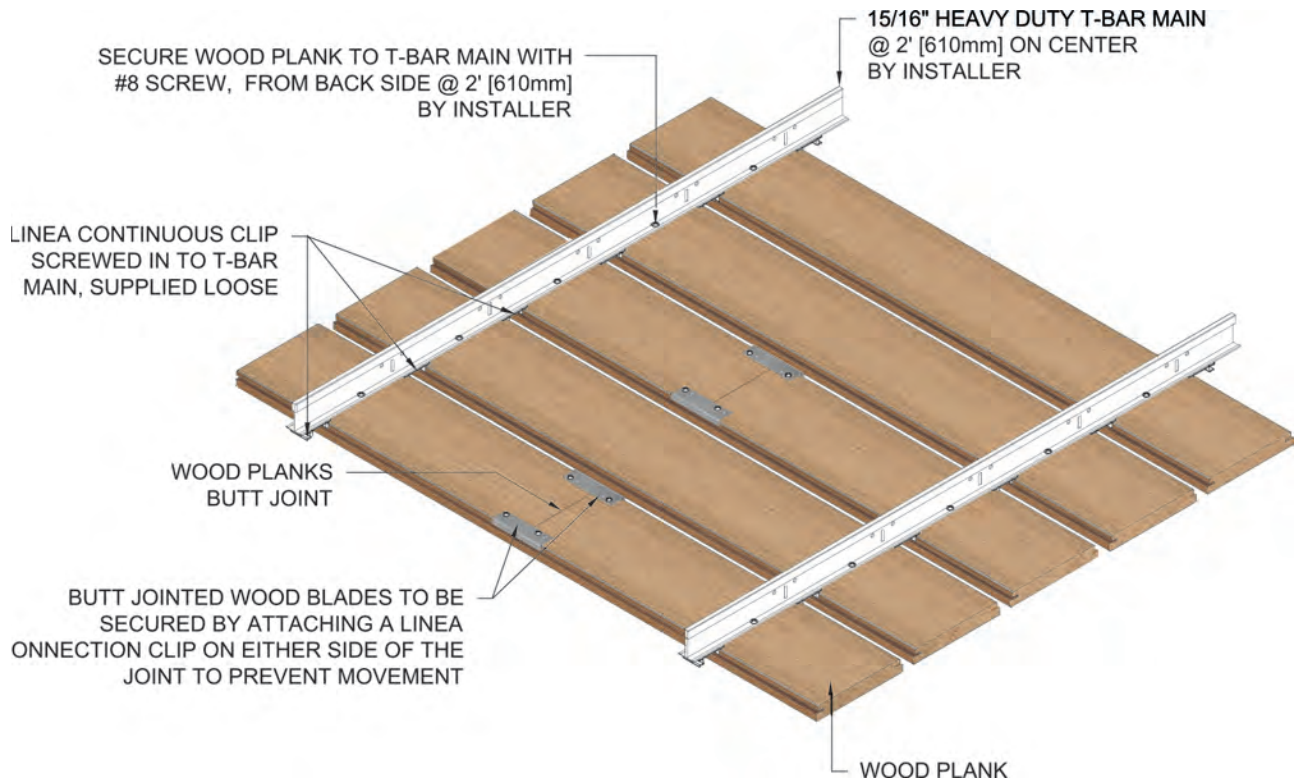

Available With:

LINEA MicroPerforations

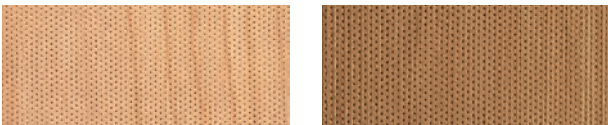

LINEA Textured Face



LINEA Textured Face with Microperforations



DISCLAIMER

A single sample may not accurately represent the full range of natural variations to be expected. Due to the inherent properties and characteristics of wood, these samples should be viewed as an approximation of what can be obtained. Some wood species have more natural variance in appearance than others. We have made every effort to make colors as accurate as possible. Colors on screen may vary depending on your screen setting and resolution. **Contact LINEA for more details.**

LINEA CONTINUOUS PLANK

PRODUCT DATA SHEET

PHYSICAL DATA

WOOD SELECTIONS	
Wood Species <i>Interior</i>	LINEA Continuous Plank may be specified in a wide variety of solid woods as well as natural or engineered wood veneers pressed on MDF core with matching edge banding
Wood Species <i>Exterior</i>	LINEA Continuous Plank may be specified in Western Hemlock, Douglas Fir, Western Red Cedar or Alaskan Yellow Cedar. LINEA Continuous Plank should be not be installed in locations in direct contact with rain, snow, standing water or prolonged direct sunlight. Soffits, overhangs and other covered spaces are ideal. Veneer/composite materials are NOT suitable for exterior environments.
FINISHES	
Finishes <i>Interior</i>	LINEA Continuous Plank for interior applications are factory finished smooth in a low VOC coating. Tinted clear finishes, custom stains and painted finishes are also available. Sheen options include matte, satin, or semi-gloss.
Finishes <i>Exterior</i>	LINEA Continuous Plank (solid wood only) for exterior applications are factory finished smooth in a low VOC coating. Tinted clear or custom stains are also available. Sheen options include matte, satin, or semi-gloss. <i>Contact LINEA for more information.</i>
Surface Texture	Surface appearance as smooth or LINEA Textured Face.
Antibacterial	LINEA offers an antibacterial coating for interior wood product installations where cleanliness and hygiene are of the utmost importance. The coating has been specially formulated to provide excellent object/surface protection levels and deliver extraordinarily high physical/chemical resistance. Furthermore, the presence of active metals boosts durability and protects the coating film from bacterial attack and the effects will last over time.
PANEL SIZES	
Module Sizes	LINEA Continuous Plank panels are manufactured and sold in multiple standard module sizes or can be customized (veneer only). Solid wood panels are provided in random lengths. Veneer/composite products are available in standard or custom widths up to 12" and are provided in 8' or 10' lengths. <i>Contact LINEA for details.</i>
Tolerances	LINEA panels are built in accordance with CISCA dimensional tolerances.
TECHNICAL DATA	
Fire Rating <i>Solid Wood</i>	Fire retardants are factory applied to all LINEA Grille wood slats prior to further finishing to achieve a Class A Fire Rating when tested to ASTM E-84 (USA) and CAN/ULC S102 (Canada). When site cutting is required, fire retardants can be re-applied to the cut locations and re-sealed to bring the panel back into compliance. Other topically applied chemical fire retardants or intumescent finishes may be used to achieve Class A Fire Rating. In some cases, the specifying consultant may need to file an Alternate Solution with local authorities for approval. LINEA suggests consulting with local building code consultants during the specifying stage to avoid any potential issues related to Fire Rating.
Fire Rating <i>Veneer/ Composite</i>	LINEA Continuous Plank panels with real wood or engineered wood veneers are laminated to Class A Fire Rated Composite MDF cores. The combination of Wood Veneer and Finish is less than 1mm thick (0.5mm in most cases) and therefore should not be considered significant to the overall rating.
Acoustics	LINEA Continuous Plank panels without additional acoustic insulation, will act as a sound diffusor and should be considered acoustically transparent. When paired with acoustical insulation or duct liner behind, the panels can achieve medium to high sound absorption
Seismic	LINEA Continuous Plank panels are engineered for applications in all seismic areas when installed <i>per LINEA installation instructions</i> . Consult local code or a licensed engineer for additional requirements.
Installation	LINEA Continuous Plank panels are progressively and directly fixed to the suspension grid using mechanical screw fasteners and alignment clips. In some instances, individual planks may need direct fastening to the suspension grid from above. Fabric and Plastic shipped loose. Local building codes or a licensed engineer should be consulted in order to determine additional seismic requirements.
Warranty	1 Year Warranty on all LINEA panel products. <i>Contact LINEA for details.</i>
SHIPPING AND SITE CONDITIONS	
Shipping	LINEA products are carefully packaged and shipped in palletized wooden crates.
Site Conditions	Wood products are hygroscopic in nature and must be stored, installed & maintained in a controlled building environment. Temperature range should be maintained between 60°–90° F (15°–32° C). Relative Humidity range should be kept within a minimum 25%–max. 55% (not to exceed 20% RH from peaks to valleys). <i>Failure to maintain site conditions will void the LINEA warranty</i>

LINEA CONTINUOUS PLANK

PRODUCT DATA SHEET



ACOUSTICS

LINEA Continuous Plank panels Can achieve medium to high NRC and SAA Ratings

MODULE SIZE	E-400 – NRC/SAA	TYPE A – NRC/SAA	TEST RESULTS DISCLAIMER
3"	0.70 / 0.71	0.70 / 0.74	Test results achieved by 3rd party, NVLAP accredited laboratory testing and in accordance with ASTM C423; Mounting per ASTM E795: Type E-400 and Type A; and achieved with 1-1/2" thick, 2 lb/ft ³ acoustical infill. Results in field may differ from test lab results due to the varying and unique environmental characteristics of each space and location.
4"	0.60 / 0.62	0.70 / 0.72	
4.5"	0.60 / 0.62	0.70 / 0.72	
6"	0.50 / 0.52	0.70 / 0.72	



Pattern Considerations

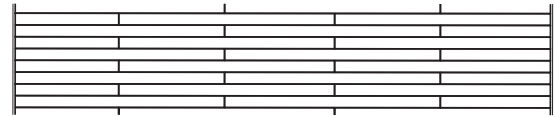

Continuous Plank | Clip Layout

Disclaimers

Appearance

Variation among wood slat appearance may occur due to the natural characteristics of real wood and wood grain. Variation may be reduced, by using custom stains, tinted clear finishes or engineered wood veneers.

Fire Performance

Individual product components (*wood, fabric, metal, finish*) comply with Class A fire retardant testing. ASTM E-84 and CAN/ULC S-102 submittal data is based on supplier tests. Product assembly testing has not been completed due to assemblies varying on a project-by-project basis. To exceed today's changing codes and environmental requirements, Linea recommends installing sprinklers in addition to WW using chemical fire retardants. Linea recommends the specifier consult a fire protection engineer, NFPA 13, and local codes for assistance where fire suppression and automatic fire detection systems are present.

Acoustics

A selection of standard LINEA Continuous Plank panels have been lab tested per ASTM C423 for Sound Absorption and Sound Absorption Coefficients by the Reverberation Room Method. This test method covers the measurement of sound absorption in a reverberation room by measuring decay rate. Due to assemblies varying on a project-by-project basis, not all configurations have been tested.



LEED®

Linea products can contribute towards LEED certification

MR-2.1 2.2	Construction Waste Management
MR-3.1 3.2	Materials Reuse
MR-4.1 4.2	Recycled Content
MR-5.1 5.2	Regional Materials (location dependent)
MR-7.0	Wood available as FSC Certified, upon request
EQ-3.1 3.2	Construction IAQ Management Plan
EQ-4.1 4.2 4.4	Low emitting materials

*Product information is subject to change without notice.

Revision Date: November 2023

T 604-776-2265 sales@lineaceilings.com lineaceilings.com 2320 Peardonville Road Abbotsford, BC Canada V2T 6J8